

**MAXAM**  
Mowers and Toppers

# Parts List and Retail Prices

## 2130 | 2500 | 3300 | MXL250 | Wilter

2023

[www.maxammowers.co.nz](http://www.maxammowers.co.nz)



**MAXAM**  
MOWERS

**30** years

## Notes:

1. All orders are subject to freight charges.
2. Orders received by 3.00 pm will be given priority dispatch.
3. Prices are effective August 2023
4. Special pricing available for Indent orders. (Stock order over \$5000)
5. All prices stated herein are Retail Prices excluding GST, and are subject to change without notice.

## Contact Details:

Farmgear Ltd, 422 Railway Road  
PO Box 4114, Palmerston North 4442 New Zealand

**\*The preferred form of contact is email\***

Email: [parts@farmgear.co.nz](mailto:parts@farmgear.co.nz)

Ph: 06 777 5387 (Spare Parts DDI)

Web: [maxammowers.co.nz](http://maxammowers.co.nz)

## MAXAM WARRANTY POLICY

1. **MAXAM** Mowers materials are and covered by a comprehensive warranty, against faulty materials and workmanship that:
  - (i) The mower is operated in normal use.
  - (ii) The mower is correctly serviced and maintained.
  - (iii) The mower is worked within its stated capacity (i.e. Horsepower limit and P.T.O. speed).
  - (iv) The mower is not subjected to any modifications or damage from improper use.
2. The term of the warranty shall be 24 months from date of installation except machines sold into the Hire Industry shall be void of warranty.
3. The following items are not covered by **MAXAM** warranty.
  - (i) Power take-off shafts and clutches.
  - (ii) Blades, tynes, belts.
  - (iii) Freight costs
  - (iv) Loss of income from the machine due to a warranty fault.
  - (v) Use of non genuine parts
4. **Any warranty claims must be authorized with a factory order before proceeding.**

# Table of Contents

Page	
1	2500 Drawing
2	3300 Drawing
3	Blades
3	Vee – Belts
4	Common Purchases
4	Skid Spindles
5	Rotors
6	Topping Skids
6	Seal Plates
7	Linkage Components
8	Paint and Decals
8	Plastic Covers and Guards
8	Miscellaneous
9	Replacement Chassis Parts
10	3300 Chassis Parts
11	Input Components
12	Wilter Parts
13	2500 Input / Idler Drawing
14	3300 Input / Idler Drawing
15	Driveshaft / PTO
16	2500 Belt Fitting
17-18	3300 Belt Fitting
19-21	MXL250 Spare Parts
22	MXL Parts Identification photo's (by number)
23	Replacing Drive Belt on MXL250
24	Replacing Wilter belt on MXL250



## MAXAM 2500 Components

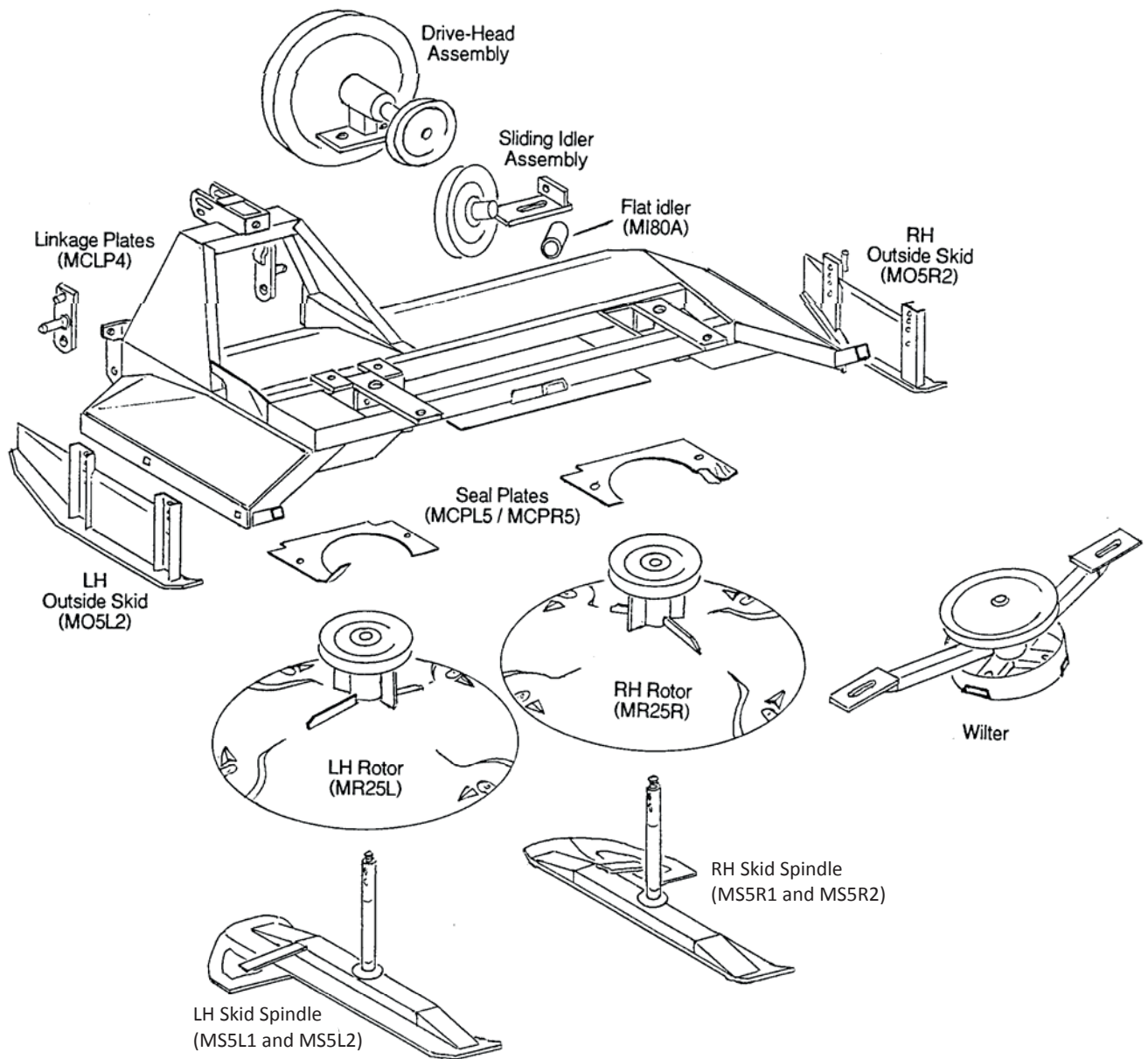

Drive Belt: MDB25 (D223.5 only)

Wilter Belt: WC95 (C95 only)

Driveshaft: 6 Series c/w Over-run clutch on mower end

Blades & Bolts: MBLR & MBB10

Wilter Tyne & Pin: WTYB & WTYP

The Current Model is 2500IV (Mk4)

## MAXAM 3300 Components

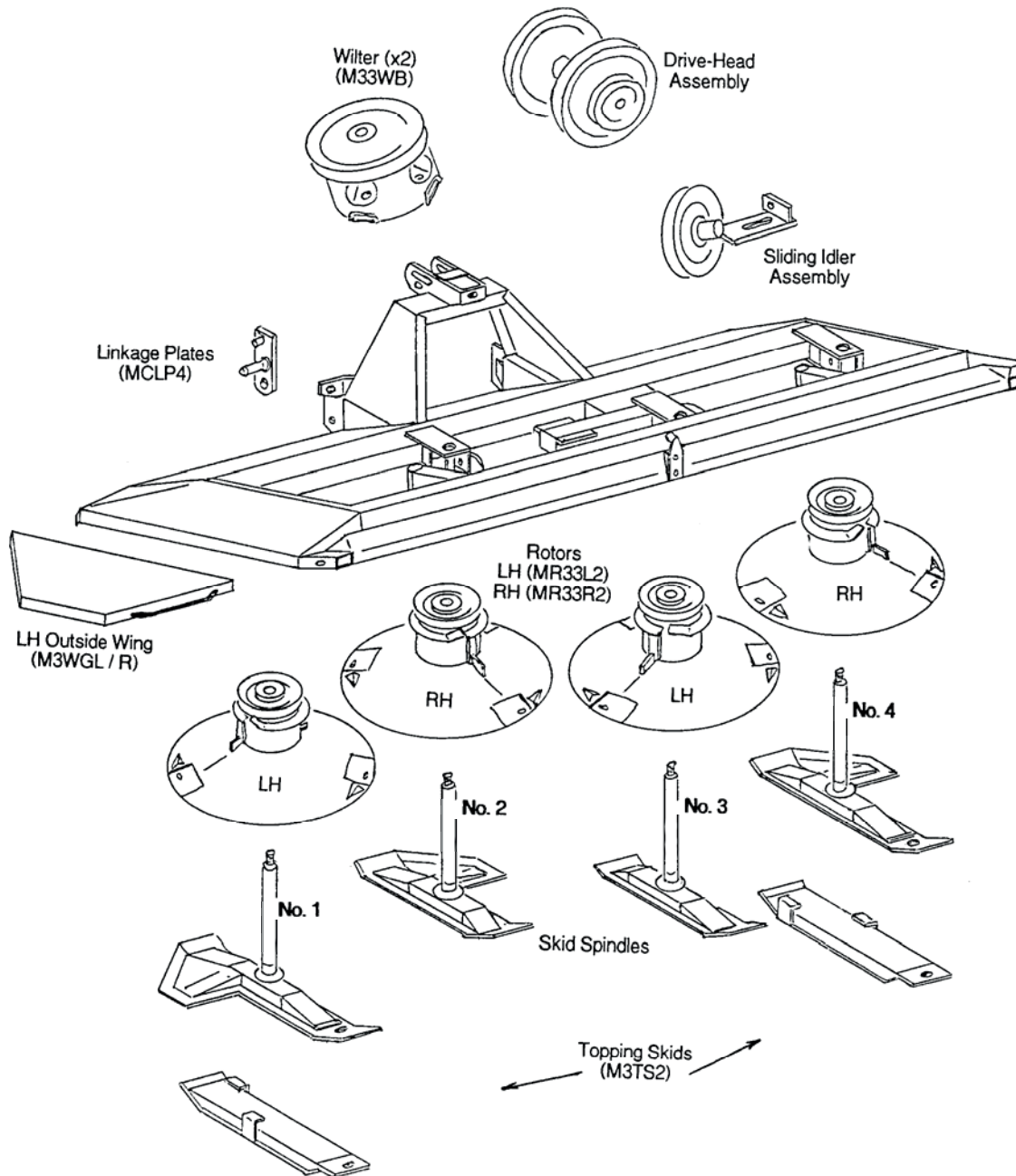

LH & RH Drive Belt: MDB33C (SPC5000)

Twin Wilter Belt: WD33 (SPC6000)

Blades & Bolts: MBLR & MBB10

Wilter Tyne & Pin: WTYS & WTYP

Driveshaft: 6 Series c/w Over-run clutch on mower end. Driveshaft can be supplied with either 1 3/8" 6 spline yoke, or 1 3/8" 21 spline yoke on the tractor end to suit your tractors' 1000 rpm system.

The Current Model is 3300V (Mk5)

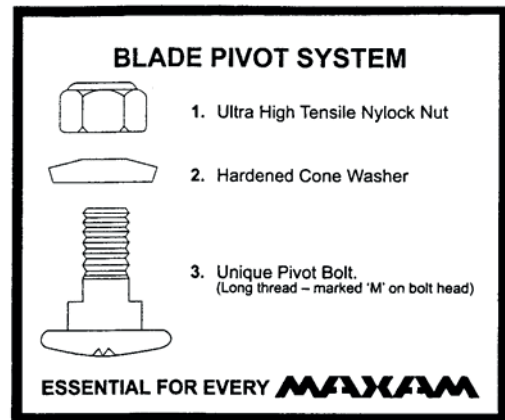
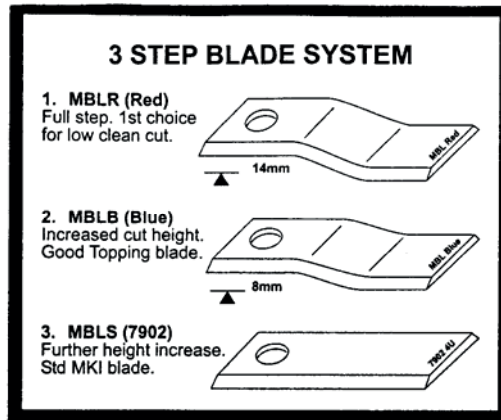

CODE	DESCRIPTION	RETAIL PRICE \$ (Excl. GST)
------	-------------	--------------------------------

### MOWER BLADES



MBLR	Red Blade (25 Blades per box)	4.25 ea
MBLB	Blue Blade (25 Blades per box)	4.25 ea
MBLS	Straight Blade (25 Blades per box)	4.00 ea
MBL3L	Special Long Blade for 3300 only	5.00 ea

### BLADE PIVOT BOLTS

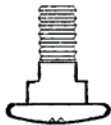

MBB10	Maxam Blade Bolt, Washer & Nut set (25 per box) *see above drawing for details	5.00 ea
FW10C	M10 Conical Washer (already supplied in MBB10 packs, but can be purchased singly/in bulk)	0.75 ea

### VEE - BELTS



MDB360	MXL250 Drive Belt	430.00
MDB25	2500 Drive Belt (MkI – IV) D223.5 only	270.00
MDB21	2130 Drive Belt (MkI – IV) D193.5	240.00
WC95	2500 & 2130 Wilter Belt	60.00
WC93	Optional Belt for MkI-III 2130's	60.00
MDB33C	3300 Heavy Duty Drive Belt (standard on new 3300's)	430.00
MDB33E	3300 Medium Duty Drive Belt	220.00
MWD33	Wilter Belt for 3300 and MXL250	220.00

### COMMON PURCHASES

MWS50	Bottom Spindle Washer (Ø50 x Ø90 x 3)	12.00
MTSB	2500 & 2130 Topping Skid Bolt & Nut	15.00
WTYB	Wilter Tyne – Bent (2500 type)	60.00
WTYS	Wilter Tyne – Straight (3300 type)	45.00
WTYP	Wilter Tyne Pin (common)	10.00

**CODE DESCRIPTION RETAIL PRICE \$**  
(Excl. GST)

**SKID SPINDLES** \*Come standard with bottom spindle washer & top spindle nut

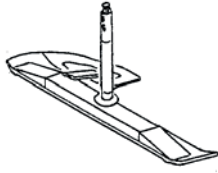

MS5L1 2500 Mkl LH Skid Spindle (M24 thread) 550.00  
MS5R1 2500 Mkl RH Skid Spindle (M24 thread) 550.00

MS5L2 2500 MkII – IV LH Skid Spindle (1" UNF thread) 450.00  
MS5R2 2500 MkII – IV RH Skid Spindle (1" UNF thread) 450.00

MS3L1 2130 Mkl LH Skid Spindle (M24 thread) 520.00  
MS3R1 2130 Mkl RH Skid Spindle (M24 thread) 520.00

MS3L2 2130 MkII – IV LH Skid Spindle (1" UNF thread) 480.00  
MS3R2 2130 MkII – IV RH Skid Spindle (1" UNF thread) 480.00

\*MkII Spindles have x2 bolt holes going through the skid spindle

MS33FL2 3300 MkII No.1 Skid Spindle (130x6x750 Base) 390.00  
MS33ML2 3300 MkII No.2 Skid Spindle (130x6x600 Base) 360.00  
MS33MR2 3300 MkII No.3 Skid Spindle (130x6x600 Base) 300.00  
MS33FR2 3300 MkII No.4 Skid Spindle (130x6x750 Base) 390.00

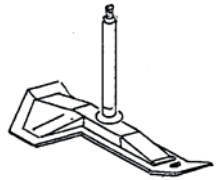

MS33FL4 3300 MkIV No.1 Skid Spindle (Square top spindle) 390.00  
MS33ML4 3300 MkIV No.2 Skid Spindle (Square top spindle) 360.00  
MS33MR4 3300 MkIV No.3 Skid Spindle (Square top spindle) 300.00  
MS33FR4 3300 MkIV No.4 Skid Spindle (Square top spindle) 390.00

\*MkIV Spindles dont have bolt holes - but have a machined square on the top of spindle.

**BOLTS, WASHERS & NUTS**

FN24 M24 Nylock Nut (Mkl Top Spindle Nut) 5.00  
FNS112 1" UNF 12TPI Nylock (MkII Top Spindle Nut) Top 8.00  
MWS262 Top Spindle Washer (High Tensile) 10.00  
FB1280 M12 x 80 HT Bolt (Mkl Spindle Bolt) 5.00  
MBS2 ½" x 3½" HT Bolt (2500 & 2130 MkII Spindle Bolt) 5.00  
MBS4 ½" x 4" HT Bolt (MKII-III 3300 Spindle Bolt) 5.00  
MW12C ½" Spindle Bolt Conical Washer 0.75  
MSCP 3300 Spindle Clamp Plate 25.00  
MWS50 Bottom Spindle Washer (common part) 12.00  
FB123 ½" x 3" HT Bolt (MKV 3300 Spindle ClampBolt) 5.00  
MS5SP1 2500 Skid Plate only (250x6x1050) 260.00  
MS5LB 2500 LH Skid Plate only (200x6x1050) 200.00  
MS5RB 2500 RH Skid Plate only (200x6x1050) 200.00  
MS3LB 3300 Long Skid Plate only (130x6x750) 150.00  
MS3SB 3300 Short Skid Plate only (130x6x600) 130.00  
MSCQL Common 3300 & 2500 LH Quadrant only (250 x 6) 100.00  
MSCQR Common 3300 & 2500 RH Quadrant only (250 x 6) 100.00  
MS5RP1 2500 Skid Front Repair Plate (250 x 6 x 250) 200.00

CODE	DESCRIPTION	RETAIL PRICE \$ (Excl. GST)
------	-------------	--------------------------------

**ROTORS** \*Come standard with x2 Bearings (M6210C) & Spacer (MR278S)

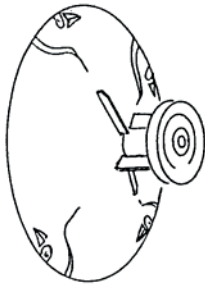

MR25L	2500 LH Rotor Mkl – IV	1500.00
MR25R	2500 RH Rotor Mkl – IV	1500.00
MR21L	2130 LH Rotor Mkl – IV	1500.00
MR21R	2130 RH Rotor Mkl – IV	1500.00
MR33L2	3300 LH Rotor (Barrel type)	1300.00
MR33R2	3300 RH Rotor (Barrel type)	1300.00

**BEARINGS & SPACERS**

M6210C	6210 C3 2RS Bearing (common on all rotors) Rotor	50.00
MR278S	Bearing Spacer 278mm (common part)	30.00

**REPLACEABLE ROTOR PARTS**

MRNP	Weld-on Nut Protectors (Arrow-Head shape) Weld-on	3.60 ea
MRFIP	Fill-in Plates (LH & RH available)	12.00 ea
MRTIS	Weld-on Wear Strips (underneath)	10.00 ea
MR290P	Rotor Pulley Plate Ø290 (one side of Vee-pulley)	30.00 ea
MCBMP2	Blade Mount Plate	30.00 ea

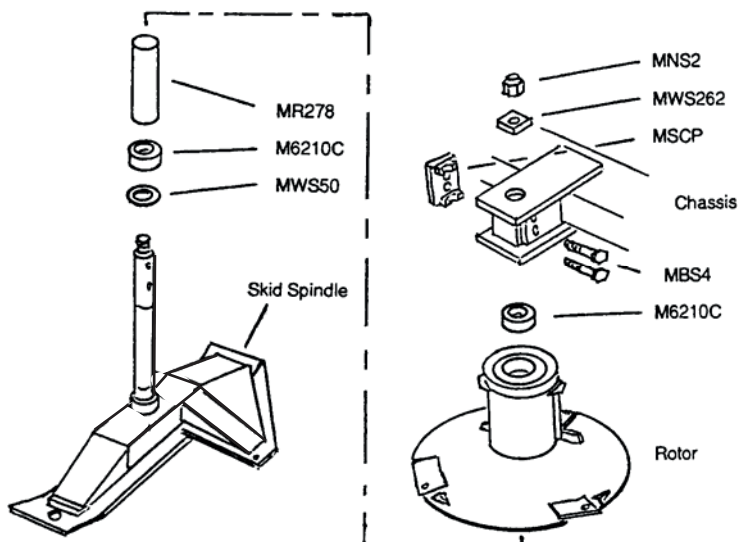

**ASSEMBLY NOTES**

- Spindle Washer must be the correct way up (Inner Race contacting Washer)
- Bottom Bearing must be mounted using LOCTITE in the Housing.
- Check under-side of Bottom Spindle plate (on chassis) for wear. There must be clearance for the outer Bearing ring to rotate.
- Ensure Spindle Bolts and top nut are kept tight.
- To ascertain Rotor direction (i.e. LH/RH), the arrow heads point in the direction of rotation; so in the middle of each pair of Rotors (1&2 / 3&4),



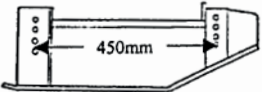
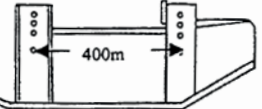
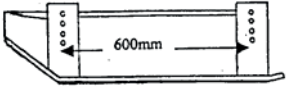
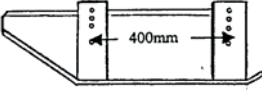

	CODE	DESCRIPTION	RETAIL PRICE \$ (Excl. GST)
<b>RIGHT HAND SIDE</b>			
	MO5R1	<b>2500 &amp; 2130 OUTSIDE TOPPING SKIDS</b> RH 2500 Mkl only ('89 – '94) Hole Centres: 450mm	450.00
	MO5R2	RH 2500 MkII – IV ('94 – current) 2130 Mkl – IV Hole Centres: 400mm	400.00
<b>LEFT HAND SIDE</b>			
	MO5L1	LH 2500 Mkl & early MkII only ('89 – '96) Hole Centres: 600mm	450.00
	MO5L2	LH 2500 MkII – IV ('97 – current) 2130 Mkl – IV Hole Centres: 400mm	400.00

Please check Hole Centre Dimension on mower to ensure correct skid is ordered.

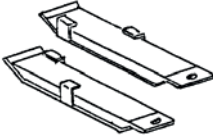
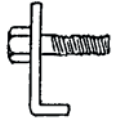
### **3300 TOPPING SKIDS** \*Come standard with bolts & nuts to mount

	M3TS2	MkII Topping Skid 40mm increase (2003 onwards)	450.00 pr
	M3TS2-20	MkII Topping Skid 20mm increase (2003 onwards)	450.00 pr
	MTSB	2500 & 2130 Topping Skid Bolt & Nut	15.00 ea
	FB1630	M16 x 30 3300 Skid Retaining Bolt & Nut	5.00 ea

### **SEAL PLATES**

	MCPL5	2500 LH Seal Plate	80.00
	MCPR5	2500 RH Seal Plate	80.00
	MCPL3	2130 LH Seal Plate	80.00
	MCPR3	2130 RH Seal Plate	80.00
	M33SP	3300 Seal Plate (No.2 Rotor)	50.00
	FB1020SS	M10 x 20 Stainless B&N (2500 & 2130)	3.00
	FB1220	M12 x 20 Z/P Bolt only (3300)	3.00
	MW12C	M12 Conical Washer (3300)	0.75

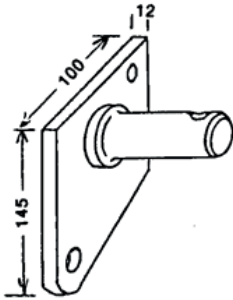

MCLPL1 (PR1 opp.)

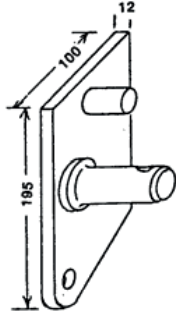

MCLPL2 (PR2 opp.)

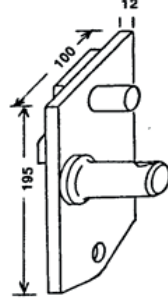

MCLPL3 (PR3 opp.)

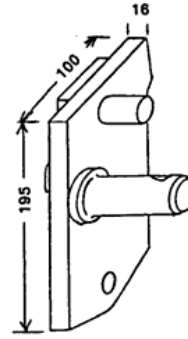

MLP33L (33R opp.)

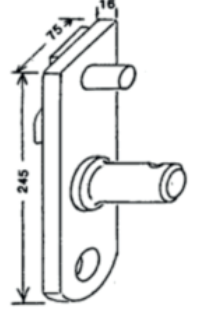

MCLP4

**CODE****DESCRIPTION****RETAIL PRICE**  
\$ (Excl. GST)**LINKAGE PLATES**

MCLPL1	2500 & 2130 Mkl LH Linkage Plate	280.00
MCLPR1	2500 & 2130 Mkl RH Linkage Plate	280.00
MCLPL2	2500 & 2130 MkII LH Linkage Plate	280.00
MCLPR2	2500 & 2130 MkII RH Linkage Plate	280.00
MCLPL3	2500 & 2130 MkIII LH Linkage Plate	280.00
MCLPR3	2500 & 2130 MkIII RH Linkage Plate	280.00
MLP33L	3300 LH Linkage Plate (2002 – 2004 models)	280.00
MLP33R	3300 RH Linkage Plate (2002 – 2004 models)	280.00
	(2001 model 3300s use 2500 MkIII Linkage Plates)	
MCLP4	2500 & 2130 MkIV & 3300 (2005-2011) Linkage Plates	240.00
MLP4L	2500 and 3300 MkIV Left Hand linkage plate (2012 - )	240.00
MLP4R	2500 and 3300 MkIV Right Hand linkage plate (2012 - )	240.00

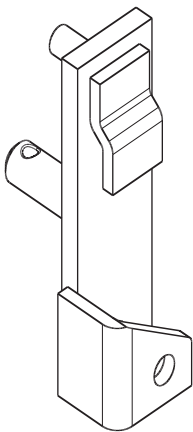
**MOUNTING COMPONENTS**

MLCS Linkage Compression Spring 70.00

MSTR Spring Tension Rod 30.00

FB1680 M16 x 80 HT Bolt (2500 Mkl Pivot Bolt) 5.00



FB1040 M10 x 40 Bolt (2500 Mkl Shear Bolt) 3.00

FB1690 M16 x 90 HT Bolt (2500 MkII &amp; III Pivot Bolt) 5.00

FB1655 M16 x 55 HT Bolt (3300 &amp; 2130 Pivot Bolt) 5.00

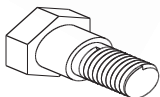

MB20LP M20 MkIV Pivot Bolt(with Ø26mm) 25.00

MTLS Toplink Compression Spring 70.00

MTLC Top-Link Sliding Clevis 100.00

MTLP Top-Link Pin (Mk IV) 10.00

MTPW Top-Link Pivoting Washer 15.00

CODE	DESCRIPTION	RETAIL PRICE \$ (Excl. GST)
------	-------------	--------------------------------



MY1000	1 litre Spraying Enamel – Maxam Yellow	150.00
MYA	Aerosol Paint Maxam Yellow	45.00

### DECAL SETS

M25D	2500 Decal Set (Please specify Mkl, II, III or IV)	70.00
M21D	2130 Decal Set ( “ )	70.00
WDC	Wilter Decal	12.00
M33D	3300 Decal Set	70.00

### PLASTIC COVERS & GUARDS

M25PC1	2500 Mkl – III Plastic Cover	500.00
M25PC4	2500 MkIV Plastic Cover (incl. Wilter Decal)	500.00
M25PC1	2130 Mkl – III Plastic Cover	500.00

M33PC	3300 Top Plastic Cover	600.00
M33LPG	3300 LH Rear Plastic Guard	120.00
M33MPG	3300 Mid Rear Plastic Guard	250.00
M33RPG	3300 RH Rear Plastic Guard	120.00
M33TS	Topping Skirt (Red)	140.00
M33TSC	3300 Topping skit clamp kit (5 pieces)	80.00
MTFK	Spring Loaded Transport Flag Kit	80.00
MTFP	Transport flag & Pole (no spring)	50.00
MTFS	Transport flag Spring only	30.00
M25TL4	2500 Weld-on Top-link	700.00
MTL25F	2500 Floating Top-link (Pre 1998)	750.00
M3WGL	3300 LH Galvanised Wing	360.00
M3WGR	3300 RH Galvanised wing	360.00
MWTK25	2500 Weight Transfer Kit	300.00
MWTK33	3300 Weight Transfer Kit	480.00

The above kits are designed to transfer up to half of the mower weight onto the tractor by means of a spring system. This results in less wear and improved ability to 'bounce' over obstacles.

MSTL33	3300 Sprung Top-link Retro-fit	480.00
--------	--------------------------------	--------

This system takes weight off the front of the mower resulting in better ground following and a flatter cut.

M33PPG	Mushroom Pin for 3300, left and right guards	20.00
--------	--	-------

CODE	DESCRIPTION	RETAIL PRICE \$ (Excl. GST)
<b><u>2500 REPLACEMENT CHASSIS PARTS</u></b>		
M25LCA	LH Clevis Assembly (Parts only)	200.00
M25RCA	RH Clevis Assembly (Pre-welded)	260.00
MCSW	Spindle Plate Repair Washer	20.00
M25LCP	Large (RH) Front Cover MK 1-4	500.00
M25MCP	Middle (LH) Front Cover MK 1-4	390.00
M25LEP	LH End Panel MK 2-4	200.00
M25REP4	RH End Panel MK 4	260.00
M25REP2	RH End Panel MK 2-3	390.00
M25LFC	LH Front Corner MK 2-4	150.00
M25RFC	RH Front Corner MK 2-4	150.00
M25BT	Belt Tray MK 1-4	260.00
MCBCB	Belt Tray Brace MK 1-4	200.00
M25CBG	Belt Guide MK 1-4	65.00
M25BGM	Back-guard Mount MK 1-3 (3mm Folded)	100.00
M25CBP	Chassis Base Plate MK 1-4	500.00

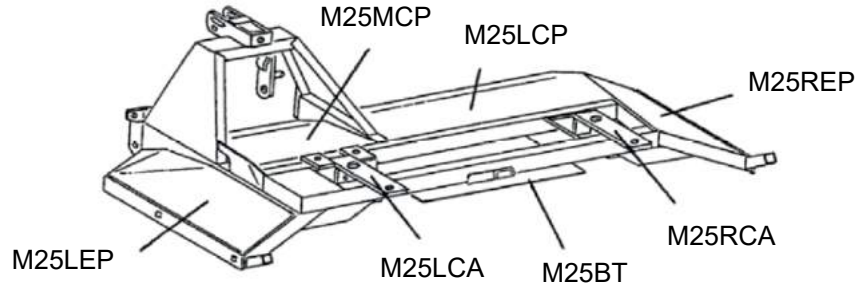

### **2130 REPLACEMENT CHASSIS PARTS**

M21LCP	Large (RH) Front Cover MK 1-4	520.00
M21MCP	Middle (LH) Front Cover MK 1-4	390.00
M21LEP	LH End Panel MK 2-4	200.00
M21REP	RH End Panel MK 2-4	260.00
M21CBP	Chassis Base Plate MK 1-4	520.00
M21LFC	LH Front Corner MK 2-4	150.00
M21RFC	RH Front Corner MK 2-4	150.00
M21BT	Belt Tray MK 1-4	260.00

- Non-current production items may incur a delayed dispatch  
 - MK1 panels are obsolete, unless stated in the description



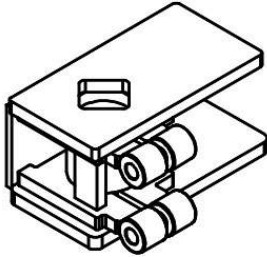

### **3300 REPLACEABLE CHASSIS PARTS**

M3CA12	MKI-III No.1 & 2 clevis parts (not welded)	200.00
M3CA3	MKI-III No.3 clevis parts (not welded)	200.00
M3CA4	MKI-III No.4 clevis parts (not welded)	200.00

M3C5A1	MKV No.1 (Far left) Square Top Clevis Assembly	250.00
M3C5A2	MKV No.2 (Mid left Square Top Clevis Assembly	250.00
M3C5A3	MKV No.3 (Mid right) Square Top Clevis Assembly	250.00
M3C5A4	MKV No.4 (Far right) Square Top Clevis Assembly	250.00

*All MkIV & MKV chassis will be supplied as MKV style clamp chassis.*

M33MFP	Mid front cover panel MK 1-4	390.00
M33LRP	LH & RH Front cover panel MK 1-4	450.00
M33LEPV4	LH End Panel MK 1-4	320.00
M33REPV4	RH End Panel MK 1-4	320.00
M33LFC	LH Front corner Panel MK 1-4	150.00
M33RFC	RH Front corner Panel MK 1-4	150.00
M33BT	Belt tray MK 1-4	520.00
M33CBP	Chassis base plate MK 1-4	390.00
MCBCB	Belt tray brace MK 1-4	200.00

CODE	DESCRIPTION	RETAIL PRICE \$ (Excl. GST)
<b><u>SHAFTS / PULLEYS</u></b>		
 MD600	2500 & 2130 Main Drive Pulley & Shaft	480.00
MD400	3300 Main Drive Pulley & Shaft	480.00
<b><u>HOUSINGS (c/w Bearings &amp; Spacers)</u></b>		
MDH1	2500 & 2130 Mkl, II & III Input Housing	400.00
MDH4	2500 & 2130 MkIV Input Housing	350.00
MDH33	3300 Input Housing	350.00
<b><u>BUSHED PULLEYS (c/w Key)</u></b>		
 WC390	3300 Main LH Drive Pulley (Ø390mm)	180.00
WC260	2500 & 2130 Wilter Drive Pulley (Ø260mm)	150.00
WC220	3300 Wilter Drive Pulley (Ø220mm)	150.00
MDD50	Dummy Bush	30.00
<b><u>BEARINGS &amp; SPACERS</u></b>		
M6210C	6210 C3 2RS Bearing	50.00
MD155S	2500 & 2130 Mkl-III Rear Input Spacer (155mm)	20.00
MD60S	2500 & 2130 Mkl-III Inner Input Spacer (60mm)	20.00
MD107S	2500 & 2130 MkIV Input Spacer (107mm) 2 / Assy.	20.00
MD128S	3300 Input Spacer (128mm)	20.00
<b><u>IDLER PULLEYS (c/w Bearings &amp; Circlip)</u></b>		
 Mi290	2500 Large Idler (Ø290mm)	240.00
Mi235	2130 Large Idler (Ø235mm)	240.00
Mi300	3300 LH & RH Large Idler (Ø300mm)	240.00
Mi220	3300 Wilter Idler (Ø220mm)	240.00
Mi80A	2500 & 2130 Flat Idler (c/w Bearing & Grease Cap)	72.00
<b><u>IDLER BRACKETS (Sliding type)</u></b>		
 Mi25TD	2500 MkIV Idler Tension Plate	160.00
Mi33TL	3300 LH Idler Tension Plate	160.00
Mi33TR	3300 RH Idler Tension Plate	160.00
Mi33TW	3300 Wilter Idler Tension Plate	160.00
<b><u>BOLTS, WASHERS &amp; NUTS</u></b>		
MB20250	2500 & 2130 Mkl-III Belt Tension Screw (M20 x 250)	17.00
FB20110	3300 & 2500 & 2130 MkIV Belt Tension Screw (M20 x 110)	15.00
MB2055D	2500 & 2130 Input Mounting Bolt, Washer & Nut (M20)	15.00
MB2055	3300 & 2500 & 2130 MkIV Idler Mounting Bolt, Washer &	8.00
FB1240	Nut 3300 Input Mounting Bolt	3.00
FB1235	3300 & 2500 & 2130 MkIV Idler Retaining Bolt	3.00
MW246	M24 x 58 x 6 Washer	7.00
MW206	M20 x 58 x 6 Washer	7.00
MW126	M12 x 58 x 6 Washer	7.00
FN24	M24 Nylock Nut	5.00
FN20	M20 Nylock Nut	4.00

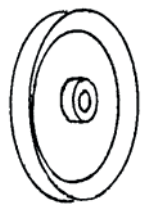
	CODE	DESCRIPTION	RETAIL PRICE \$ (Excl. GST)
	MWKO	Kit to fit Old 2500s (Pre 1993) with short Input Shafts	3200.00
	MWKN	Kit to fit MkII & III 2500 & 2130s with long Input Shafts	2500.00
	M25WK4	Kit to fit MkIV 2500 & 2130's (2005-)	2000.00
	M33WK	3300 Wilter Kits	2000.00
<b><u>WILTER KITS</u></b>			
<b><u>LARGE WILTER COMPONENTS (2500 Type unless stated)</u></b>			
	MWSA	Wilter Spindle / Spider Assembly	500.00
	WBC	Wilter Cover (Black – c/w Decal)	130.00
	WTP	Wilter Tension Plate (MkI-III incl. Bolt)	55.00
	M33WB	3300 Wilter Body c/w Bearings & Spacer	750.00
<b><u>BELTS, PULLEYS &amp; IDLERS</u></b>			
	MWD33	3300 Twin Wilter Belt	220.00
	WC95	2500 & 2130 Wilter Belt	60.00
	WC93	Optional 2130 Wilter Belt	60.00
	WC390	Wilter Driven Pulley (Ø390mm)	180.00
	WC260	Wilter Drive Pulley (Ø260mm)	150.00
	WC220	3300 Wilter Drive Pulley (Ø220mm)	150.00
	Mi220	3300 Wilter Idler c/w Bearing & Circlip (Ø220mm)	240.00
	Wi190	Wilter Reverse Idler c/w Bearing (Ø190mm)	240.00
<b><u>TYNES &amp; PINS</u></b>			
	WTYB	Wilter Tyne – Bent (2500 type)	60.00
	WTYS	3300 Wilter Tyne – Straight	45.00
	WTYP	Wilter Tyne Pin (common)	10.00
	WLP8	8mm Lynch Pin	2.00
<b><u>BOLTS, NUTS &amp; WASHERS</u></b>			
	FB20110	M20 x 110 – Wilter Tension Bolt & Nut (MkIV-)	12.00
	MB20WL	M20 x 55 – Wilter Mount Bolt, Washer & Nut	12.00
	MW246	M24 x 58 x 6 Washer	7.00
	FN24	M24 Nylock Nut	5.00
<b><u>BACKGUARDS KITS</u></b>			
	WBGK	Kit for any 2500 & 2130 Maxam Wilter mower (except 2500 MkIV) Includes Tee-bar, LH Upright, Pipes & Bolts	240.00
	MBGK	Non-Wilter Backguard Kit c/w Dummy Bush (to replace WC260 pulley), Y Piece, Pipes & Bolts	150.00
	MBGF4	MkIV Backguard Front Piece (Bolts to chassis)	120.00
	MBGT4	MkIV Backguard Tee-bar	70.00
	M3BGH	3300 backguard V - Bar	70.00
	MB1250	M12 x 50 Bolt	2.00
	MW126	M12 x 58 x 6 Washer	7.00
	MBGP	Backguard Pipes (Specify LH or RH & Model)	25.00 ea

**2500 & 2130 INPUT HOUSING ASSEMBLY**

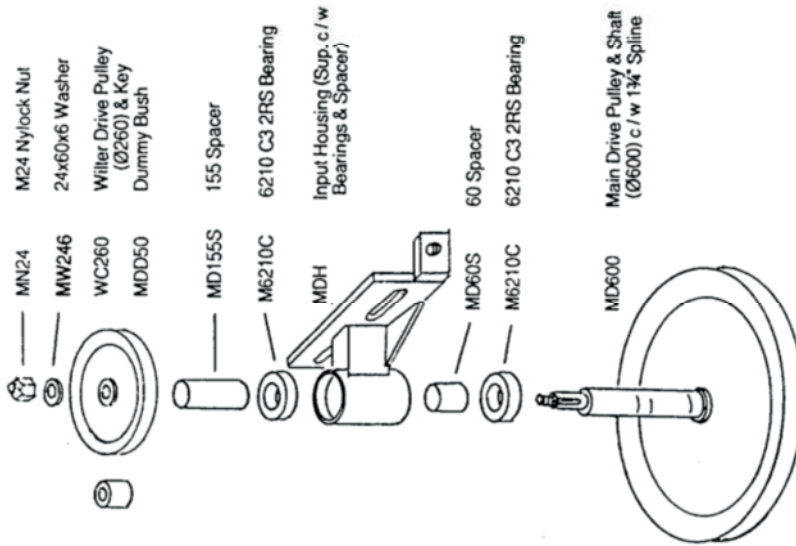

**2500 & 2130 IDLER ASSEMBLY**

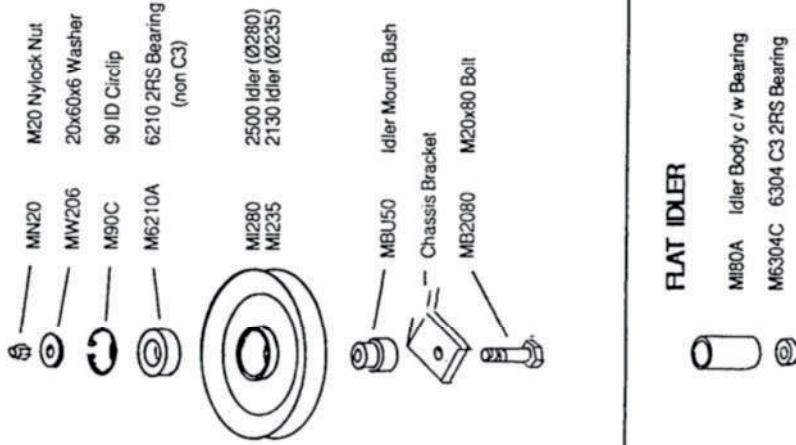

**FLAT IDLER**

- M80A Idler Body c/w Bearing
- M6304C 6304 C3 2FRS Bearing

**WILTER ASSEMBLY (2500 TYPE)**

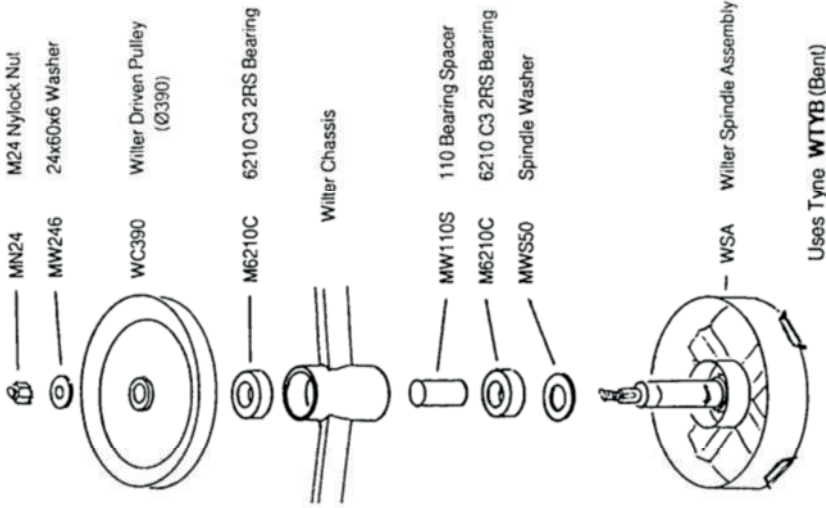

Uses Tyne **WTYB** (Bent)

**ASSEMBLING NOTES**

- Spindle Washer must be the correct way up on Wilder (Inner Race contacting Washer)
- Wilder Pulleys (Driver & Driven) must be assembled with the protruding part of the Bush facing the Housing.
- Pulleys should be assembled using an Anti-seize to aid dis-assembly.
- Flat Idler Bearing should be replaced annually. It is a press fit. Use a C3 Bearing.
- Input Housing problems usually stem from lack of Drive-shaft maintenance. Grease Regularly

**Wilder Idler**





**3300 IDLER ASSEMBLY**

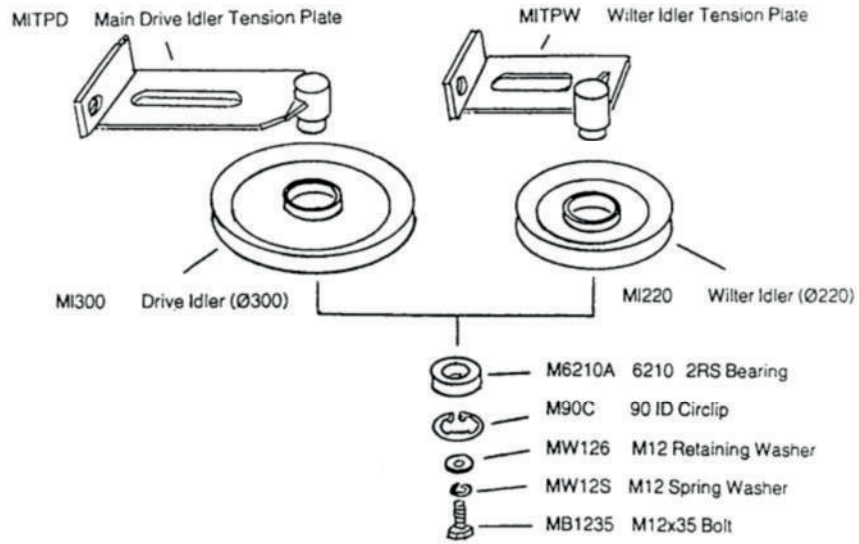

**3300 INPUT HOUSING ASSEMBLY**

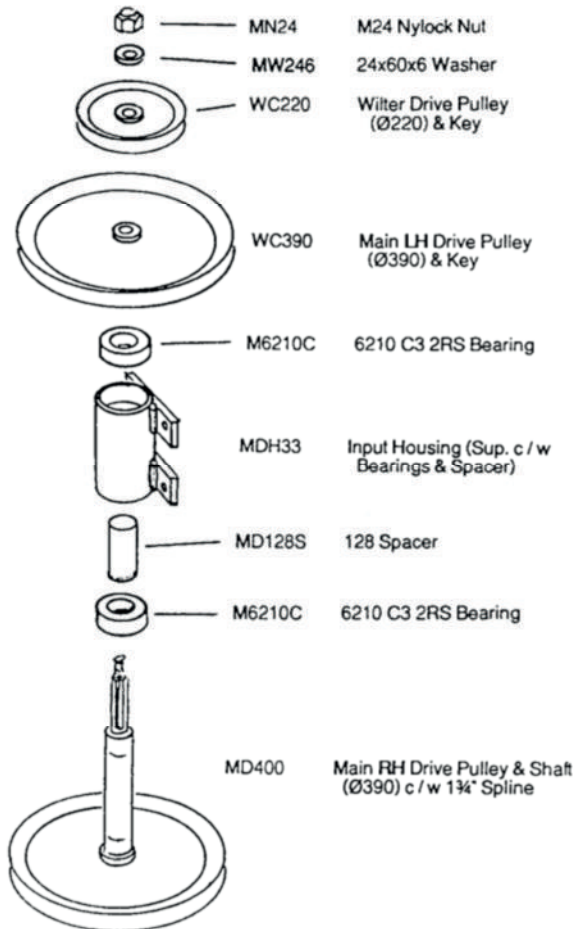

**3300 WILTER ASSEMBLY**

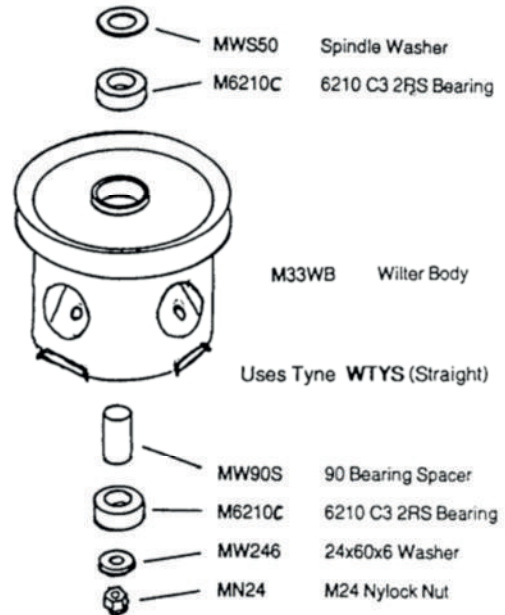

**ASSEMBLING NOTES**

- Spindle Washer must be the correct way up on Wilter (Inner Race contacting Washer)
- Input Pulleys (Ø390 & Ø220) must be assembled with the protruding part of the Bush facing the Housing.
- Pulleys should be assembled using an Anti-seize to aid dis-assembly.

CODE	DESCRIPTION	RETAIL PRICE \$ (Excl. GST)
<b><u>COMPLETE DRIVESHAFTS</u></b>		
MDC6	STD MAXAM Driveshaft c/w 1 3/4" Over-run Clutch and 1 3/8" QR Yoke (710mm closed centres)	1200.00
MDC6/21	As above but with 21 spline QR yoke for some 3300s	1200.00
<b><u>REPLACEMENT YOKES &amp; CLUTCHES</u></b>		
6 Series (30.2 x 92 cross)		
M3DY6	1 3/8" QR yoke, 6 spline (tractor end)	150.00
M3DY21	1 3/8" QR yoke, 21 spline (tractor end)	150.00
MDOC6	1 3/4" Over-run clutch (mower end)	500.00
MDOSC6	1 3/4" Over-run / Slip Clutch Combi unit (mower end)	1000.00

#### Notes on Driveshaft's

Mowers prior to 1996 were not supplied with Over-run clutches.

Tractors with PTO Brake **MUST** have an over-run clutch fitted to avoid damage to the tractor or mower.

Fitting a slip clutch or comi unit is a good option for tractors with aggressive PTO engagement or other starting problems.

MAXAM does not supply repair elements or kits for driveshafts or clutches.

## FITTING INSTRUCTIONS FOR NEW VEE BELT TO MAXAM 2500 & 2130

1. (a) Remove plastic cover and silver seal plates from around rotor pulleys (4 x M10 bolts).
- (b) Release tension of Wilter belt.
- (c) Loosen large drive pulley mount bolts (M20) and;
  - (i) on MkI, II & III mowers, undo long belt tension screw and slide drive-pulley assembly as far to the right as possible.
  - (ii) on MkIV mowers, remove sliding idler assembly from its mount (its best to leave the tension screw threaded into the bracket a bit).

2. (a) Lay out belt behind mower and grasp as shown. (b) Twist arms **LEFT over RIGHT** to form a figure "8" like this.

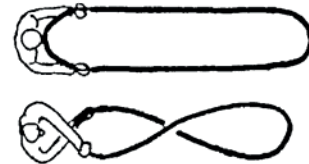

3. Lift mower off the ground and slip the twisted belt up onto rotors (from beneath the machine).

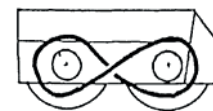

4. (a) Fit belt into rotor pulley vees. The large drive pulley may need to be rocked back to allow the belt to fit into the LH rotor pulley.
- (b) Replace the rotor seal plates.
- (c) Pull belt out to rear of mower and grasp as shown.

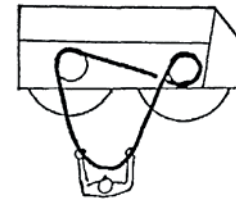

5. (a) Twist arms **RIGHT over LEFT**. Fold loop forward and feed through chassis to form a vertical loop in front of the large drive pulley.
- (b) Fit belt to all pulleys (replace idler on MkIV mower) and check rotation of all components.

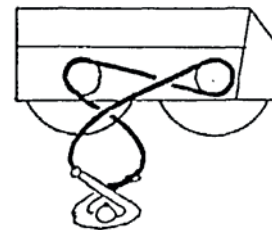

### 6. Tightening Belts:

- (a) (i) On MkI, II & III mowers, tighten main tension screw. Rotate the rotors by hand while doing this to ensure even tension. Tighten up bolts.
- (ii) On MkIV mowers, tighten up the drive-head mounting bolts. Tighten belt tensioning screw on sliding idler. Rotate the rotors by hand while doing this to ensure even tension. Tighten Idler mount bolt (M20).

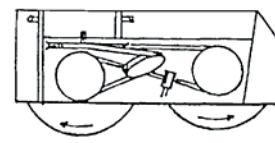

- (b) Re-tension Wilter belt, and replace cover.
- (c) Check belt tension after about an hours work. On MkIV mowers the belt tensioning for the Main drive and the Wilter are independent. On MkI, II & III mowers, the Wilter belt must be loosened off first, then the main belt tightened, then the Wilter belt re-tensioned last.

Read section on page 3 of Handbook: BELT TENSION & CARE

## 3300 INSTRUCTIONS FOR FITTING VEE BELT TO LH ROTORS (No. 1 & No. 2)

- Remove top plastic cover and LH rear plastic guard.
  - Loosen off LH side sliding idler, and remove Wilter belt from its drive pulley by releasing the belt tension (RH rear idler).
  - Remove silver seal plate from **No. 2** rotor (2 x M12 bolts).

Lift mower off the ground.

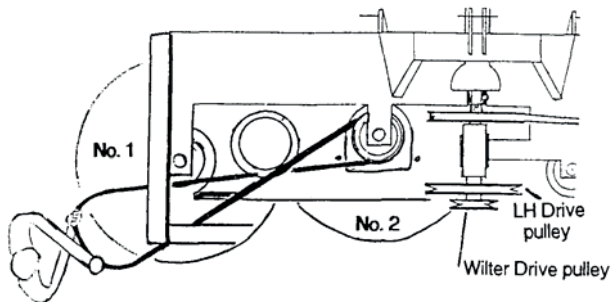

- Feed belt loop down through chassis behind No.2 rotor (where seal plate was) and slip belt loop under the rotor.
- Fit **LH** length of belt into gap in sealing ring and rotate rotor clockwise to lift belt up into rotor pulley.
- Pull free loop of belt out to LH rear of mower. Grasp belt as shown and twist arms **LEFT over RIGHT** to form a figure "8" like this.

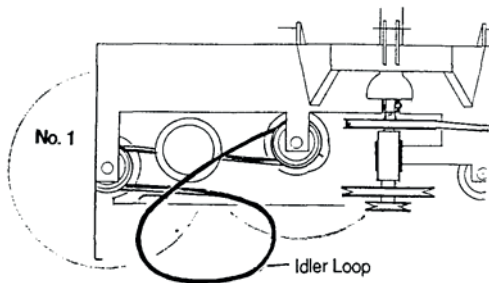

- Now the tricky bit: Slip the lower / front length of belt under the **No. 1** (Far LH) rotor. Fit this same length of belt into the gap in the sealing ring on this rotor and rotate it anti-clockwise to lift the belt up into the rotor pulley.
- Belt should now easily twist **Right over Left** to create the idler loop as shown.

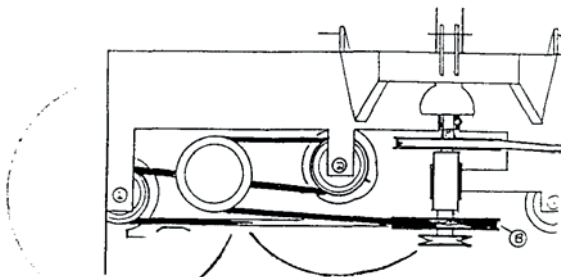

- Fit the belt into all of the pulleys and check rotation.
- Tension the belt, rotating the rotors by hand while doing this to ensure even tension.
- Re-fit other belts to their pulleys and tension up. Ensure all bolts are tight.
- Replace guards and top cover.

### INSTRUCTIONS FOR FITTING 3300 WILTER BELT

- Remove top plastic cover and all rear plastic guards.
  - Loosed off Wilter idler (RH rear idler). Both Drive belts can remain tensioned while working on Wilter Belt.
- Fit belt onto LH and RH Wilters. Ensure there are no twists in the rear length of belt and that it is not caught on any of the pins underneath.
  - Grasp the front length of belt as shown. Roll top of belt backwards (throttle-twist) a full turn (i.e. 2 actions) and twist arms **Right over Left**. This should happen easily and will naturally create the idler loop.

**More instructions at the bottom of the next page**



## 3300 INSTRUCTIONS FOR FITTING VEE BELT TO RH ROTORS (No. 3 & No. 4)

1. - Remove top plastic cover and RH rear plastic guard.  
- Loosen off all belt tensions (3 sliding idlers) and remove both LH Drive Belt and Wilter Drive Belt from their drive pulleys.

2. - Lift mower off the ground and loop belt under **No. 4** rotor (far RH rotor).  
- Fit **LH** length of belt into gap in sealing ring and rotate rotor clockwise to lift belt up into rotor pulley.

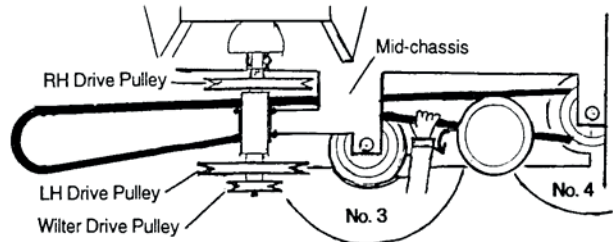

3. - Feed free loop of belt under mid-chassis (in front of **No. 3** rotor) and pull belt through as shown (there should be no twists in the belt yet).  
- Grasp the rear length of belt as shown with one hand either side of the **No. 3** rotor. Twist belt backwards (throttle-twist) half a turn.

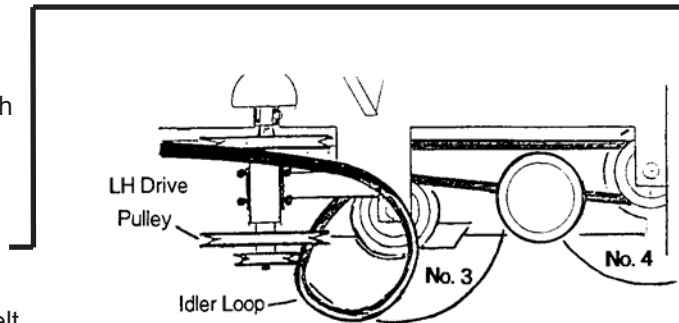

4. - Now move LH belt loop up and over the LH Drive pulley (slip the lower length of belt under it) to create the idler loop.

5. - Fit the belt into all of the pulleys and check rotation.  
- Tension the belt, rotating the rotors by hand while doing this to ensure even tension.

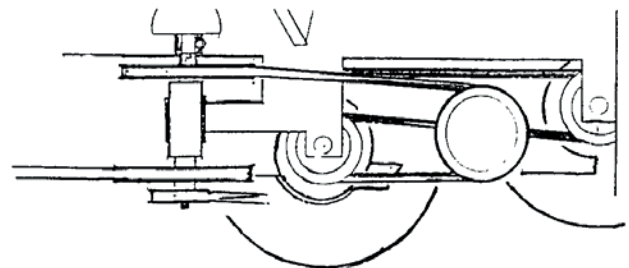

6. - Re-fit other belts to their pulleys and tension up. Ensure all bolts are tight.  
- Replace guards and top cover.

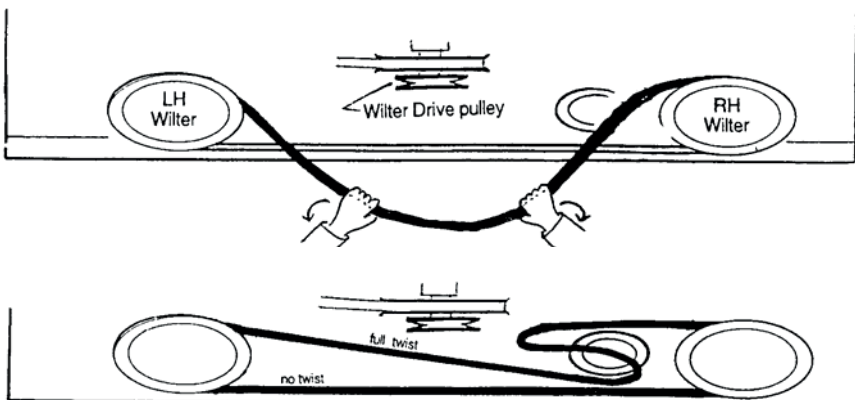

3. - Fit belt to all pulleys.  
**Check Carefully!** Belt Often falls out of large Wilter pulley. Twists Must occur in correct Belt length.  
- Tension the belt, rotating doing this to ensure even tension.  
- Replace rear guards and top cover.

#	CODE	DESCRIPTION	RETAIL PRICE \$ (Excl. GST)
<b>1. <u>Mower Blades</u></b>			
	MBLR	Red Blade	4.25 ea
	MBLB	Blue Blade	4.25 ea
	MBLS	Straight Blade	4.00 ea
<b>2. <u>Blade Bolts</u></b>			
	MBB10	MAXAM Blade Bolt (Including washer and nut in packs of 25)	5.00 ea
<b><u>Vee Belts</u></b>			
3.	MDB360	MXL250 Drive Belt	430.00
4.	MWD33	MXL250 Wilter Belt	220.00
<b><u>Skid Spindles</u></b>			
5.	MSXLL	MXL250 LH Skid Spindle	750.00
6.	MSXLR	MXL250 RH Skid Spindle	750.00
<b><u>Rotors</u></b>			
7.	MR25L	2500 LH Rotor (incl Bearings and spacer)	1500.00
8.	MR25R	2500 RH Rotor (incl Bearings and spacer)	1500.00
<b><u>Bearings and Spacers</u></b>			
9.	M6210C	Rotor Bearing 6210C3 2RS	50.00
	MR278S	Rotor Bearing Spacer	25.00
	M6304	Idler Bearings 6304	20.00
<b><u>Topping Skids (Optional)</u></b>			
	MXTS40	Under Rotor Topping Skid (Pair)	700.00
<b><u>Covers and guards</u></b>			
10.	MXTCF	Top cover frame front	600.00
11.	MXTCR	Top cover frame rear	550.00
12.	MXTCS	Top cover Stay	35.00
	MB1040	Top cover Stay bolt	5.00
	MXLPCL	Black plastic belt cover	600.00
13.	MXLPVC	Yellow PVC cover	800.00

#	CODE	DESCRIPTION	RETAIL PRICE \$ (Excl. GST)
<b><u>Idler Pulleys</u></b>			
14.	Mi80FL	Small idler with flanges (6304 C3 Bearing)	80.00
15.	Wi150V	Wilter V groove idler "	120.00
16.	Wi190	Wilter flat idler "	150.00
		Washer for bottom small idler	7.00
17.	Mi80Wa		
<b><u>Main Idler Components</u></b>			
18.	MI290	Large Idler (290mm) (Incl 6210 Bearing)	240.00
19.	MXLLIM	Large Idler slide mounting	240.00
20.	FB2040	Drive Belt locking bolt and nut	10.00
21.	MB20170	Drive Belt tension screw	20.00
<b><u>Wilter Components</u></b>			
22.	FB20110	Wilter Belt tension screw	15.00
23.	MB20WL	Wilter mount bolt washer and nut	12.00
24.	a MWBBG	Wilter bolt on belt guide (under pulley)	40.00
	b WTYB c	Wilter Tyne – Bent (2500type)	55.00
	WTYP d	Wilter Tyne Pin (common)	10.00
	WLP8	8mm Lynch Pin	3.00
<b>25. <u>Latch System</u></b>			
	a MXLA	Latch	200.00
	b MB20120	Pivot Bolt for latch	8.00
	MXLR4	Latch Rope (4m)	8.00
	MXLP	Rope pulley	30.00
	d FB1040	Rope pulley bolt	3.00
	MXTLS	Latch spring	30.00
	MXLRS	8mm shackle for rope	15.00
<b><u>Linkage Components</u></b>			
26.	MCLP4	RH Linkage Plate	240.00
27.	MCLPLX	LH Linkage Plate (M6 Grease nipples)	240.00
28.	MLCS	Linkage compression spring	70.00
29.	MSTR	Spring tension Rod	30.00
30.	MB20LP	Linkage plate pivot bolt	20.00
<b>31. <u>Transport Lock on LH Linkage</u></b>			
	a MXTL	Transport Lock	250.00
	b MXTLS	Spring for MXTL	30.00
	c MXTLC	Clamp for MXTL	25.00
	d MB1265	Bolt for MXTLC	5.00

#	CODE	DESCRIPTION	RETAIL PRICE \$ (Excl. GST)
<b><u>Input Drive system</u></b>			
32.	MD600XL	Main Drive pulley and shaft	600.00
33.	MDHXL	Input housing incl bearings (6210 C3) Mount	350.00
34.	MB1240	bolts for input housing	5.00
	MD85S	Input housing spacer	20.00
35.	WC390	Wilter Driven pulley (390mm)	180.00
	MW246	Wilter pulley washer	7.00
	FN24	Wilter pulley nut	5.00
36.	<b><u>Main Pivot</u></b>		
37.	MDU4040	DU Bush for main pivot (2)	20.00 ea
	MXMPW	Washer for main pivot	15.00
	MXMPB	Bolts for main pivot (M12x25 cap head)	5.00
<b><u>Hydraulics</u></b>			
38.	MXLHR	Hydraulic Ram	1000.00
39.	MX4225K	Hydraulic Hose Assembly (2)	100.00 ea
40.	MXHHC	Hydraulic hose clamp	20.00
41.	MXHRP	Pins for ram Incl lynch pins	15.00
42.	<b><u>Weight Transfer Parts</u></b>		
	MXLWTS	Extension spring (560mm)	150.00
	WTCH	8mm chain	10.00
	WT10SH	10mm shackle	5.00
	WT1P	1" Top Link Pin (Std)	30.00
	WT3/4P	¾" Top Link Pin	30.00
	WTCAP	Case IH Top Link Pin	30.00
	WT16SH	16mm Shackle	8.00
<b><u>Black cover support</u></b>			
42. a	MXCRE	Cover retainer 'E shape'	70.00
b	MB1240	Retainer 'E' Bolt	3.00
<b><u>Top Link system</u></b>			
43 a	MTPW	Top-Link Pivoting Washer	15.00
b	MB1040	Bolt for MTPW	2.00
44	MXTLP	MXL250 Top link pin	6.00
45	<b><u>Driveshaft</u></b>		
	MDC6XL	MXL Driveshaft – c/w 1 ¾" over-run clutch and 1 3/8" QR Yoke (565mm closed centres)	1150.00



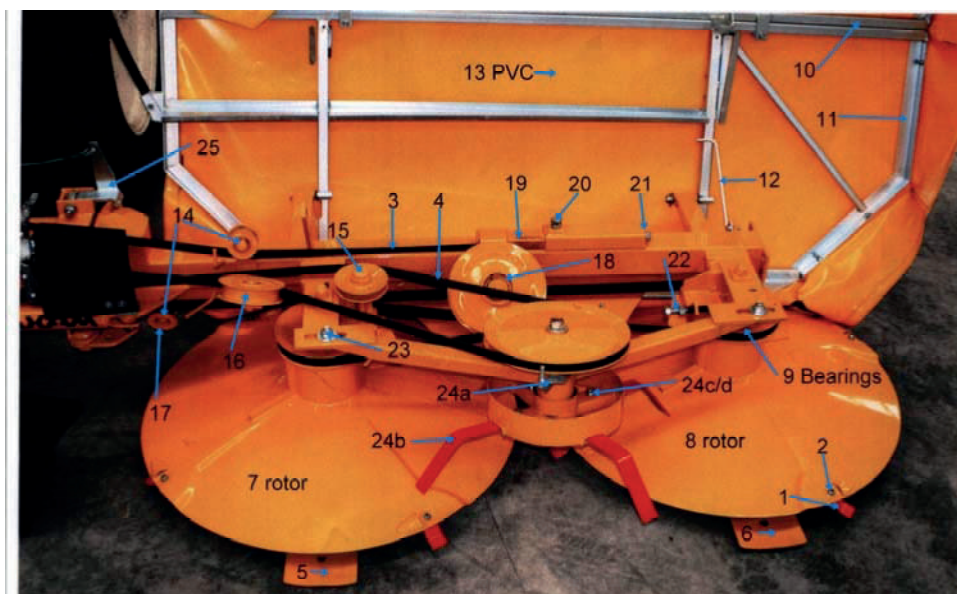
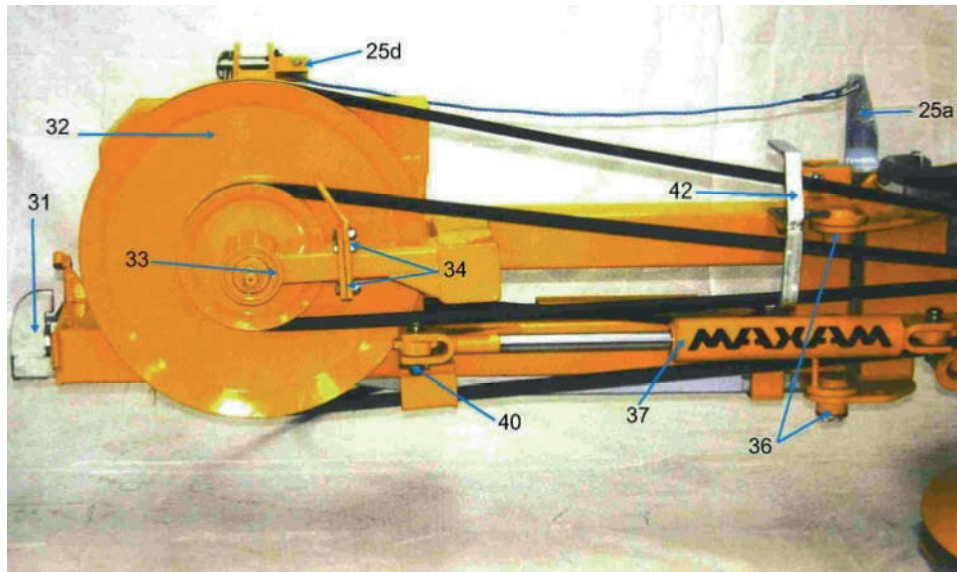
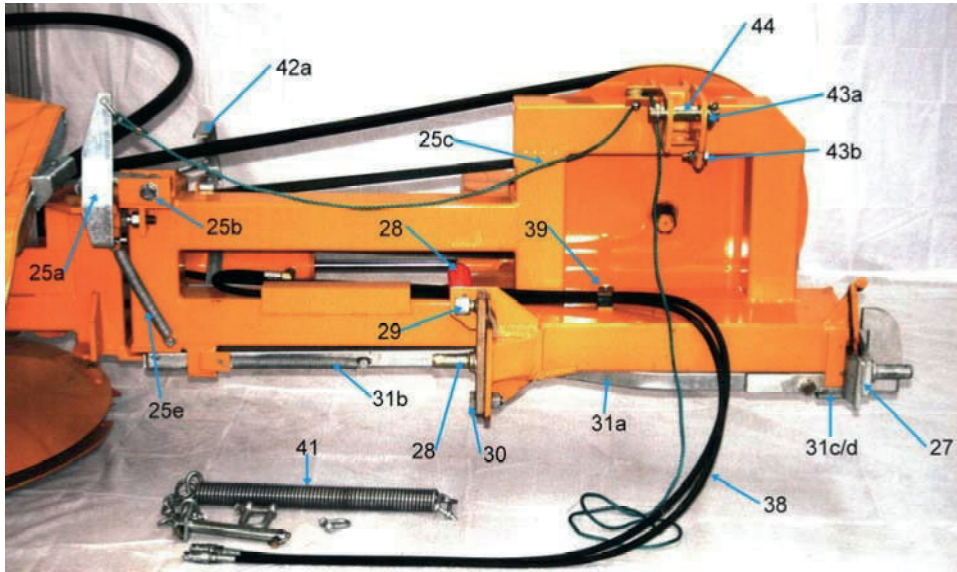

## MAXAM MXL 250 - Replacing Main Drive Belt (MDB360)

1. Fold mower out into mowing position.

Remove Black plastic cover, lift top PVC cover and fold up Stay Rod.

Loosen Main Idler clamp bolt and Belt tension screw (ideally leave the screw threaded into the bracket a bit), then slide the Idler far left.

Loosen off Wilter Mount bolts and Belt tension screw.

Slide the Wilter far left and **remove the Wilter belt** from off the mower.

Remove LH Wilter Mount bolt so the Wilter is hanging off the RH Mount bolt only. Swing Wilter backwards a little.



2. Lift the mower off the ground and fit new belt up onto RH rotor only. Pull the free loop of belt around in front of the LH rotor, and out to the LH rear of the mower. Fit the belt up onto the Belt Tray and seat the belt into the RH rotor pulley. There should be no twists or cross-over's in the belt at this stage.



3. Follow the belt length through from the **front of the RH rotor pulley** and onto the Bottom Flat Idler (wide side of belt against Idler).

**Fold the mower backwards a little** and tuck the belt around the belt

retaining hook (behind / underneath the ram), into the belt guide and around the large Main Drive pulley.

Return mower to mowing position.

- Check at this point to ensure that there is only a natural Quarter-twist in this long bottom belt length.

4. Continue following the belt down under the top arm of the silver bracket and into the Top Flat Idler.

By now, a natural loop will be forming around the LH rotor pulley.

Grasp the belt between the rotor pulleys and give the belt a throttle-twist. This will ensure the correct seating of the belt in the pulleys.



5. Seat the belt into the LH rotor pulley, tucking the belt under the hook at the rear of the LH rotor.

Fit / roll the belt into Main Idler pulley.

Re-mount the Wilter onto the LH mount bolt.

6. Check that the Drive belt is sitting correctly in all of the pulleys and idlers and is not snagged on any of the belt retaining hooks. Tension the Main Idler, rotating the rotors by hand while doing so to spread the tension evenly. When the correct tension is attained, tighten clamp bolt.

For instructions on Belt Tension and Care, see Page 5.

7. Re-fit the Wilter belt, following instructions outlined on Page 7.

**Wilter belt can easily be fitted wrong. Take care – Follow instructions.**





## MAXAM MXL 250 - Replacing Wilter Belt (MWD33)

1. Fold mower into mowing position.  
Remove Black plastic cover, lift top PVC cover and fold up Stay Rod.  
Loosen off Wilter Mount bolts and Belt tension screw.  
Slide the Wilter as far left as possible.

2. Feed loop of belt behind plastic panel and through the silver Belt  
Fit belt to Ø260 Drive pulley (small pulley behind PTO / Input shaft),  
tucking the belt around the top retaining hook, and over the  
Ram mount plate.

**It is very easy to get this belt fitted wrong.  
FOLLOW NEXT INSTRUCTIONS VERY CLOSELY.**

3. Follow the length of belt from the **Top** of the Ø260 Drive pulley down  
and around the Reverse Idler (wide side of belt against Idler),  
then on to the **LH / Rear** side of the Ø390 Driven pulley.
4. Now follow the belt through from the **bottom** of the Ø260 Drive pulley  
up and around the small Vee Idler, and back to the **RH / Front** of the  
Ø390 Driven pulley.

- Rotate mower by hand to check Direction of rotation – Wilter must throw grass to the **Left**.  
Check belt is sitting correctly in all pulleys. Ensure there are no unnecessary twists or cross-over in the belt.

5. Tension the Wilter belt, again rotating the rotors by hand while doing so to spread the tension evenly.  
When the correct tension has been attained, tighten mounting bolts and lock nut.



